

# RECOSTAL® BT

2024.04\_01\_EN

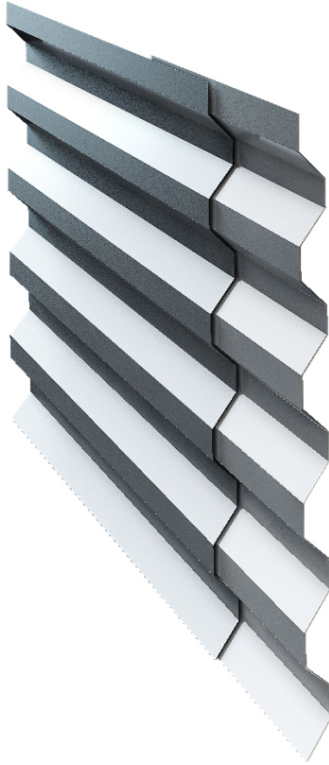

RECOSTAL® BT is a permanent formwork made of trapezoidal metal sheet. Used in shoring: ceilings, foundations, retaining walls and other underground parts of building. RECOSTAL® BT also allows salvaging of steel sheet piles.

## Main Characteristics

- Not self-supporting
- Height manufactured by order
- Fast installation
- Installation without a crane
- Various uses

## Technical Data

- Material: galvanized profiled metal sheet
- Thickness: 0.5 mm, 0.7 mm, 1.2 mm, 1.5mm
- Unit height: by order
- Unit length: 225 cm
- Packaging: packed on pallets, shrink wrapped

## Installation

RECOSTAL® BT should be installed temporarily to the sheet piles. Place reinforcement of the walls and external formwork. After concreting of the walls, fill the spaces between sheet piles and RECOSTAL® BT using ground. Remove sheet piles.

## Related Products

- RECOSTAL® 3000
- RECOSTAL® 3000 F
- RECOSTAL® Foundation Formwork
- FORDECK 1000

## Safety/ Recommendations\*

Wear protective gloves.

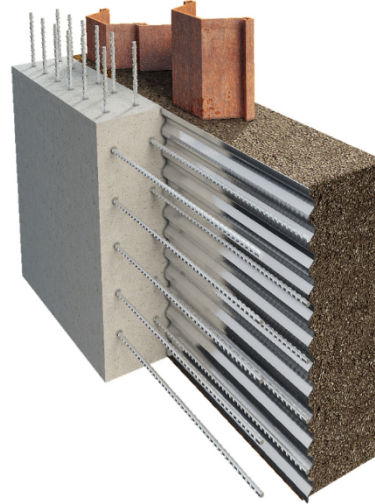

\*The recommendations relating to the application and end-use of our products are based on our current knowledge and experience of the products when properly stored, handled and applied under normal conditions. No warranty in respect of merchantability or of fitness for a particular purpose, nor any liability arising out of any legal relationship whatsoever, can be inferred either from this information, or from any other advice offered. The user shall rely on his or her own information and tests to determine suitability of the product for the intended use. We reserve the right to update information due to technical progress.